

ORIOLE 3x AF-ZOOM HD-SDI BOARD CAMERA GLOBAL SHUTTER HD-SDI / EX-SDI / CVBS AS-BCAM-3SG42-00-A



- Up to 1080p 60fps
- HD-SDI/EX-SDI/CVBS output
- VISCA and Pelco-P/D support
- Sony global shutter sensor

FEATURES

- 1/1.8" Global Shutter Sony Pregius IMX265LQR sensor.
- 1080p - 60/50/30/25 fps, 720p - 60/50/30/25 fps.
- Full HD autofocus-zoom camera.
- Lens: 12-40mm.
- Optical zoom: 3x, Digital zoom: 1x-6x.
- Digital Noise Reduction (2D+3D DNR).
- Privacy Mask Function.
- Intelligent Motion Detection.
- External trigger.
- High Light Compensation (HLC).
- VISCA, Pelco-D/P Control Protocol.



AS-BCAM-3SG42-00-A

Dimensions

Side

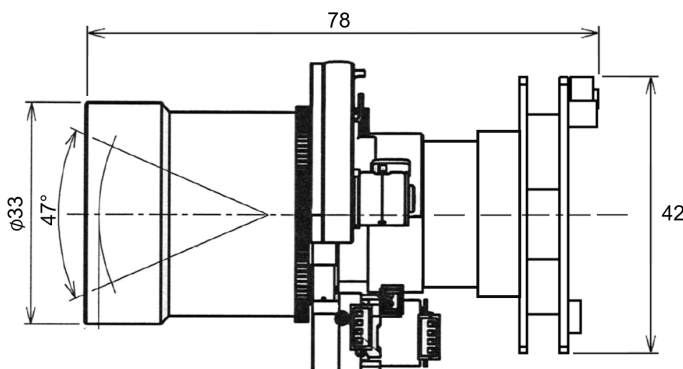

Rear

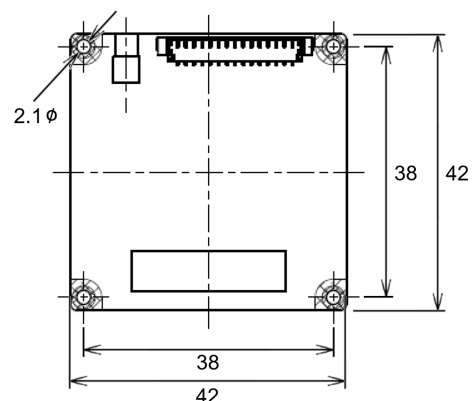

AS-BCAM-3SG42-00-A			
Total Pixels	2,064 (H) x 1,554 (V) 3.21M Pixels	Active Pixels	1,920 (H) x 1,080 (V) 2.07M Pixels
Video Modes	1080p/60(50)fps, 1080p/30(25)fps, 720p/60(50)fps, 720p/30(25)fps;	Minimum Illumination	Color (1/30s) : 0.3 lux , BW (1/30s) : 0.02 lux
Analog SD	CVBS; resolution: 700TVL	Lens	12-40mm
FOV (Field of View)	D: 43.3°-14.3° H: 33.9° -11.5° V: 25° – 8.6°	Shutter Speed	1/30(1/25) - 1/10,000 sec
		Digital Zoom	OFF / ON (1x – 6x)
DNR ¹	OFF / 2D / 3D / 2D+3D (Auto/Low/Middle/High)	Digital Slow Shutter (DSS)	Off / 2x / 3x / 4x / 5x / 6x / 7x / 8x / 9x / 10x / 12x / 15x
AGC (Gain)	ON / OFF	Brightness	0 - 20 steps
BLC² / HLC³	ON / OFF	White Balance	Auto/One Push/Manual/Indoor/Outdoor
Day & Night	Auto / Day / Night / Ext-in	Sharpness	0 - 20 steps
Motion Det.	ON / OFF (4 regions)	Privacy	ON / OFF (8 masks)
Defog	OFF / Manual (0-11 steps)	Mirror	OFF / H / V / H&V
ACE ⁴	OFF / Manual (0-11 steps)	Video Output	SDI/EX-SDI - MMCX connector
Control Protocol	Serial VISCA Pelco-D / Pelco-P	Baud Rate	2400 / 4800/ 9600 / 19200 / 38400 / 57600 / 115200
Voltage	12V DC ±10%	Current	350mA
Storage	-20°C – +60°C (Humidity: 0%RH – 90%RH)	Operation	-10°C – +50°C (Humidity: 0%RH – 80%RH)
Dimensions	42x42x15mm (boards); 78x51x51mm ⁵ ; (LxWxH)	Weight	108g

1: Digital Noise Reduction 2: Back Light Compensation 3: High Light Compensation 4: Adaptive Contrast Enhancement 5: With lens/mount; width and height is 2x max radius



ORDERING INFORMATION

PART NUMBER	DESCRIPTION
AS-BCAM-3SG42-00-A	Oriole 3x AF-Zoom HD-SDI Board Camera with Global Shutter.

CONTACT DETAILS

Headquarters:

Active Silicon Ltd
Pinewood Mews, Bond Close, Iver,
Bucks, SL0 0NA, UK.

Tel: +44 (0)1753 650600
Fax: +44 (0)1753 651661
Email: info@activesilicon.com
Website: www.activesilicon.com

North America:

Active Silicon, Inc.
479 Jumpers Hole Road, Suite 301,
Severna Park, MD 21146, USA.

Tel: +1 410-696-7642
Fax: +1 410-696-7643
Email: info@activesilicon.com
Website: www.activesilicon.com

07-Aug-2023 BCAM-3SG42